

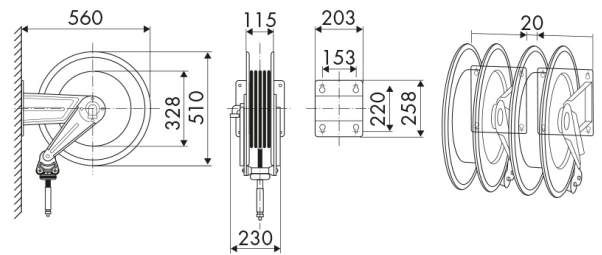

ART. 8530.250

Fixed hose reel, s.530, for hot water, 100 bar, without hose. Inlet-outlet G 1" (f)



Features

Pressure
Compatible fluids
Swivel joint
Seals
Characteristic
Material
Couplings
Hose
Ø and hose length
Inlet
Outlet
Reel flow path

Value

100 bar
water max 130 °C
AISI 304 stainless steel
Viton®
fixed
painted steel
-
-
-
G 1" (f)
G 1" (f)
AISI 304 stainless steel - zinc plated steel

RAASM S.p.A.

via Marangoni 33, 36022 - S. Zeno di Cassola (VI) - ITALY
Tel. 0039 0424 571111 - Fax. 0039 0424 571135

info@raasm.com - www.raasm.com

Copyright © 2020 All rights reserved to RAASM S.p.A.