

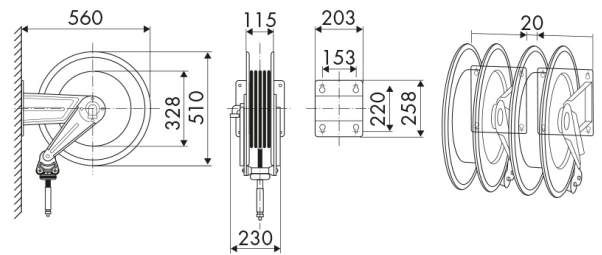

## ART. 8530.102

Fixed hose reel, s.530, for air-water, 20 bar, with black rubber hose 25 m,  $\varnothing$  1/2"



### Features

Pressure  
Compatible fluids  
Swivel joint  
Seals  
Characteristic  
Material  
Couplings  
Hose  
 $\varnothing$  and hose length  
Inlet  
Outlet  
Reel flow path

### Value

20 bar  
air - water  
brass  
Viton®  
fixed  
painted steel  
zinc plated steel  
p/n 996.225  
 $\varnothing$  1/2" - 25 m  
G 1/2" (f)  
G 1/2" (m)  
brass - zinc plated steel

RAASM S.p.A.

via Marangoni 33, 36022 - S. Zeno di Cassola (VI) - ITALY  
Tel. 0039 0424 571111 - Fax. 0039 0424 571135

info@raasm.com - www.raasm.com

Copyright © 2020 All rights reserved to RAASM S.p.A.