



ADVANCED FLUID  
MANAGEMENT SOLUTIONS

**RAASM S.p.a.**

Via Marangoni 33, 36022

S. Zeno di Cassola (VI) Italy

Tel. +39 0424 570891

info@raasm.com

## P/N 7562001.450

Manual hose reel s. 500, for oil and similar, 150 bar, without hose. Drum width 600 mm. Inlet-outlet G 1/2" (f)

### AREAS OF USE

Agriculture, Manufacturing industry, Mining industry, Shipping and offshore, Railway transport

### FEATURES

Pressure	150 bar
Compatible fluids	oils and similar products
Swivel joint	zinc plated steel
Seals	polyurethane
Characteristic	fixed
Material	painted steel
Couplings	-
Hose	-
Ø and hose length	-
Inlet	G 1/2" (f)
Outlet	G 1/2" (f)
Reel flow path	zinc plated steel



### OVERALL DIMENSIONS (mm)

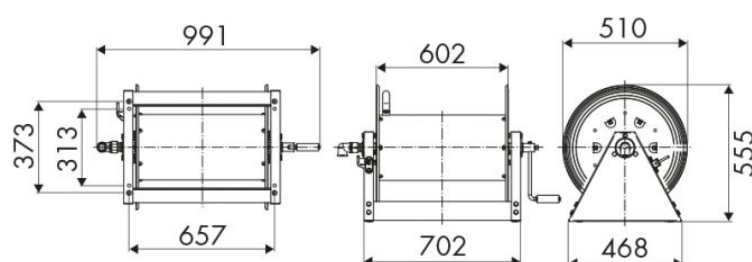

### HOSE REELS CAPACITY

Ø 1/4"	Ø 3/8"	Ø 1/2"	Ø 3/4"	Ø 1"
400 m	280 m	220 m	110 m	70 m